

2

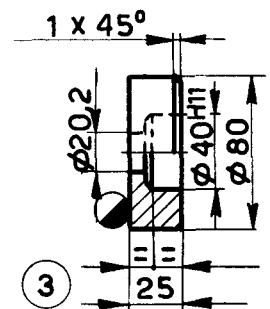

3

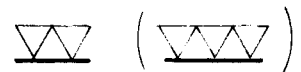

15	PUNZONE	1	∅42 x 103	C	10	Cem. e temp.
14	VITE 6 x 15 UNI 870	1		C	21	
13	MONTANTE	2	∅40 x 387	C	10	
12	TRAVERSA	1	73 x 73 x 273	Fe	42	
11	DADO 12 UNI 205	2		C	21	
10	BRACCIO	1	∅25 x 532	C	10	
9	VITE 10x20 UNI 870	1		C	21	
8	ROSETTA 10,5 UNI 1734	1		Fe	42	
7	ROSETTA 13 UNI 1734	2		Fe	42	
6	CONTRAPPESO	2	∅120 x 45	G	00	
5	VITE DI PRESSIONE	1	∅62 x 545	C	21	
4	BASE	1	30 x 385 x 205	A	00	
3	ANELLO DI RINFORZO	2	∅82 x 30	A	00	
2	GHIERA	1	∅82 x 25	C	10	Cem. e temp.
1	DADO 20 UNI 205	4		C	21	
POS.	DENOMINAZIONE	QUANT.	DIMENS. GREZZO	MATERIALE	NOTE	

TOLLERANZE

TEMPO CONCESSO

SCALA 1 : 4



ESERCIZIO
PROPOSTO DA